

NOTES:

- ① DO NOT USE ACCESSORIES MOUNTING HOLES TO MOUNT LASER.
- ② DO NOT REMOVE MOUNTING FEET.
- ③ BEAM PATH MAY NOT BE CENTERED OR PERPENDICULAR TO FACEPLATE APERTURE.

REV	ECD	DATE	DESCRIPTION	DB
C	3912	6-Aug-08	ADD BEAM EXIT Ø, CONVERT TO SOLIDWORKS	DMD
D	4107	8-Sep-09	ADD NOTE 3	DMD

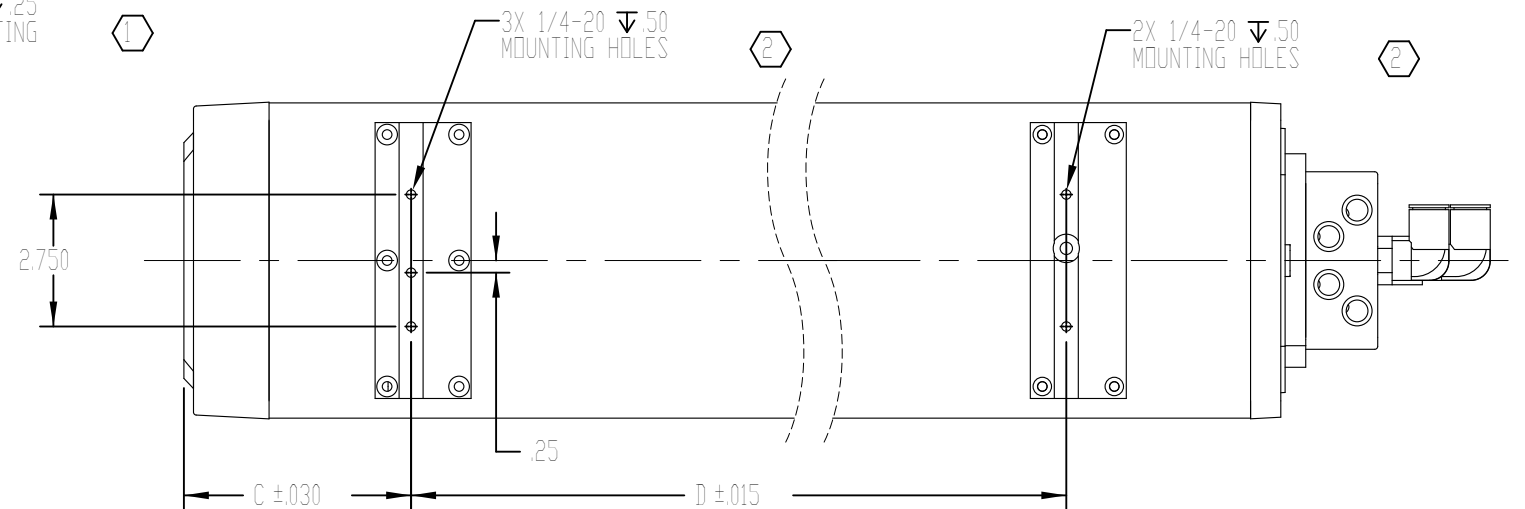
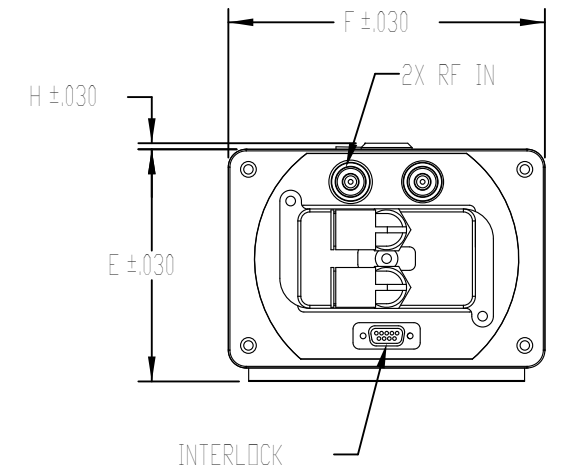
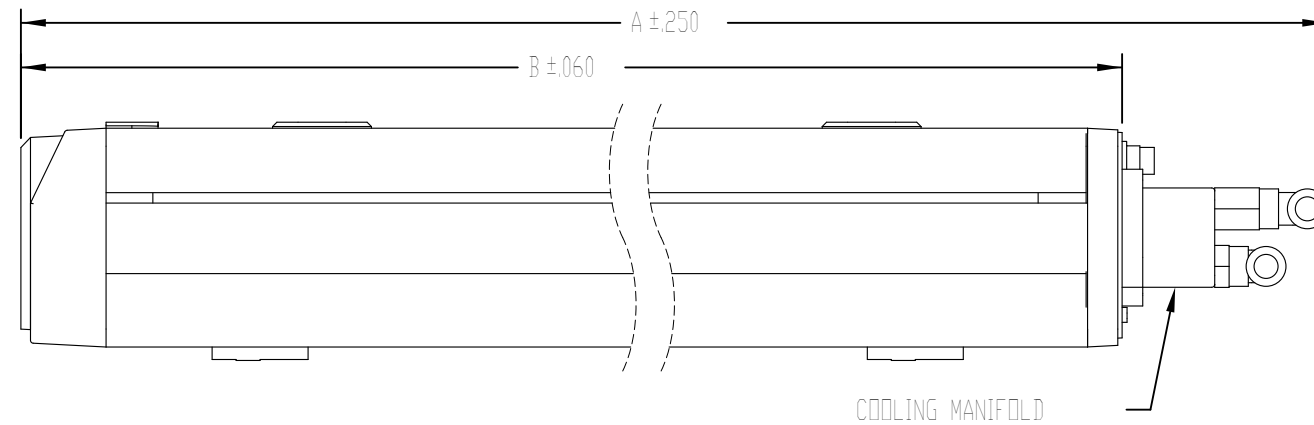
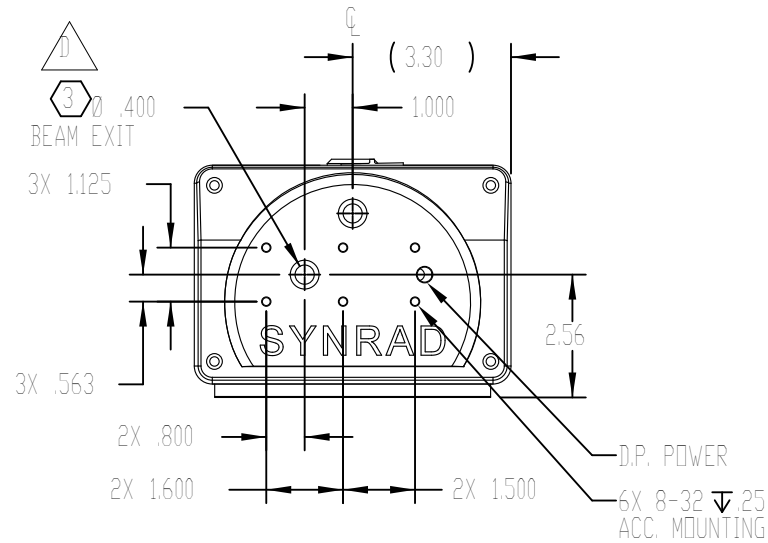
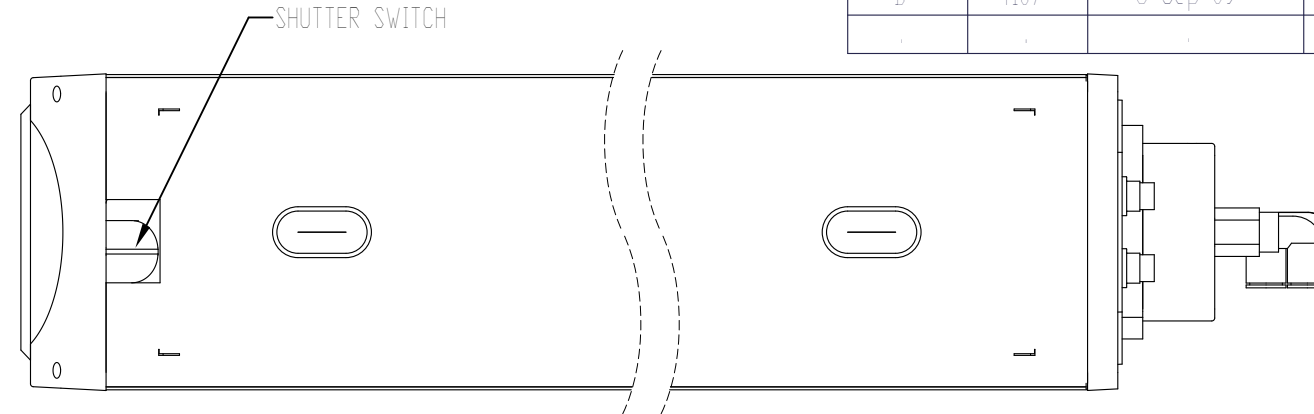

PART NUMBER	DESCRIPTION
85-017484-01	100E
85-017484-04	100SE
85-017487-01	125E
85-017487-02	125SE

	DIM A	DIM B	DIM C	DIM D	DIM E	DIM F	DIM H
100E	41.835	37.325	5.125	28.000	4.840	6.600	.200
125E	48.835	44.325	4.625	36.000	4.840	6.600	.200
57-1	41.610	37.250	5.125	28.000	4.940	6.500	.370
60-1	48.610	44.250	4.625	36.000	4.940	6.500	.370

TOLERANCES UNLESS NOTED:	
.x = ± 0.1	ANGLE = ± 2.0 °
.xx = ± 0.02	
.xxx = ± 0.005	
MATERIAL:	
FINISH:	

PROPRIETARY  
THIS DRAWING IS PROPRIETARY TO  
SYNRAD INC. AND SHALL NOT BE  
USED OR DISCLOSED IN WHOLE  
OR IN PART WITHOUT WRITTEN  
PERMISSION OF SYNRAD INC.

DESCRIPTION:  
OUTLINE & MOUNTING, 100/125 EVOLUTION

PART NUMBER: SEE TABLE

SHEET 1 of 1

UNITS: Inches

SIZE: B

SYNRAD INC.  
4600 Campus Place  
Mukilteo, WA 98275  
Phone: (425)349-3500  
Fax: (425)349-3667

DWG/FILE NUMBER: 300-17617-01	
DRAWN BY: A. Dexter	DATE: 26-May-98
CHECKED BY:	DATE:
APPROVED BY:	DATE: