

REV	ECO	DATE	DESCRIPTION	DB
C	3169	1-Mar-06	REVISED NOTE ON FRONT VIEW	KOJ

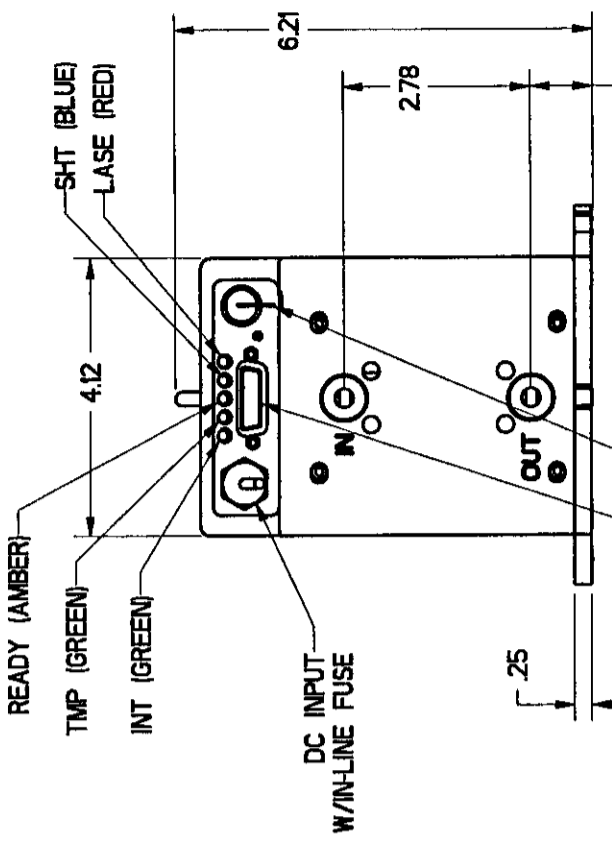

NOTES:

- 1 THIS MOUNTING HOLE PATTERN USED WHEN TOP ACCESS FASTENING DESIRED.
- 2 THIS MOUNTING HOLE PATTERN USED WHEN BOTTOM ACCESS FASTENING DESIRED.
- 3 HARDENED BALL MOUNTING POINT, 3X (Ø.1875 BALL BEARING)
- 4 KEYSWITCH VERSION ONLY.

PART NUMBER	MODEL
FSV20KW	KEY
FSV20SW	OEM

Pro/E

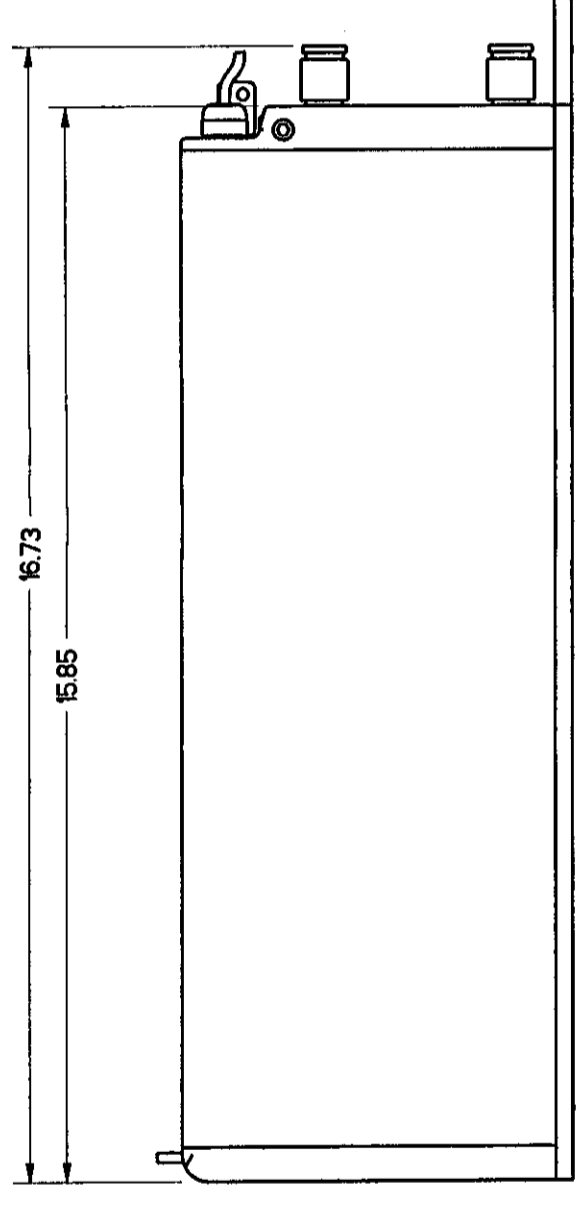

6X 8-32UNC ACCESSORY MOUNTING HOLES. SCREWS SHOULD NOT EXTEND MORE THAN 0.19" INTO FACE PLATE.

5 VDC ACCESSORY POWER

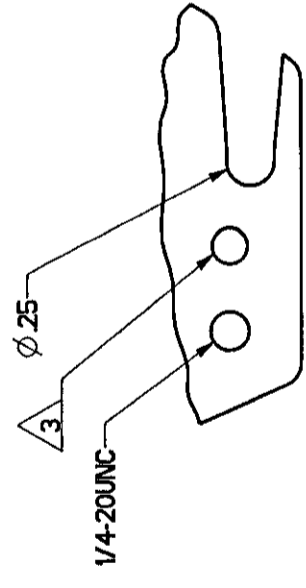
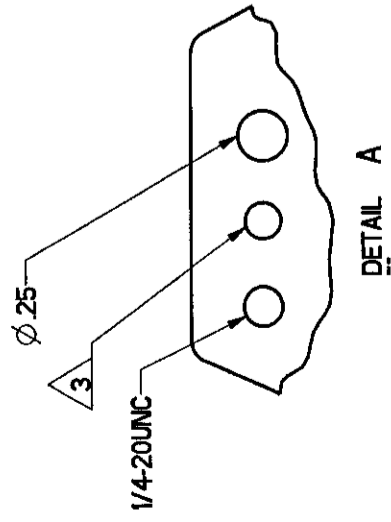
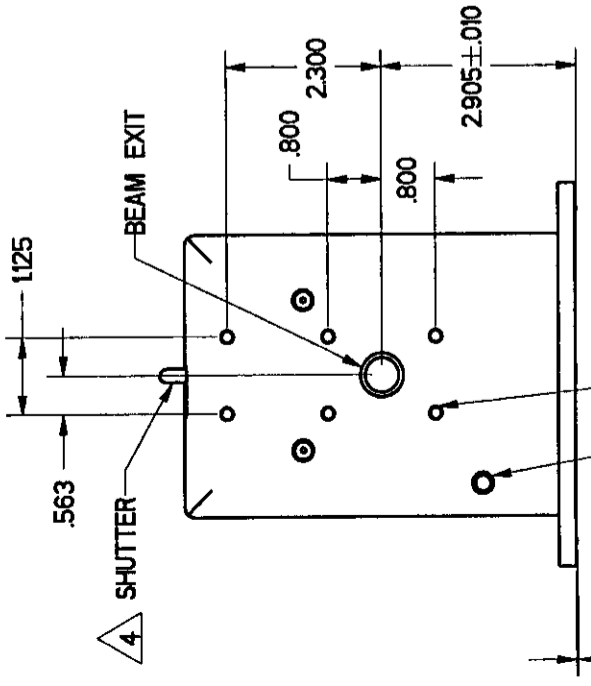

TOLERANCES UNLESS NOTED:

- .x : ±0.1 ANGLE : ±2.0°
 - .xx : ±0.01
 - .xxx : ±0.005
- MATERIAL:

PROPRIETARY
THIS DRAWING IS PROPRIETARY TO SYNRAD INC. AND SHALL NOT BE USED OR DISCLOSED IN WHOLE OR IN PART WITHOUT WRITTEN PERMISSION OF SYNRAD INC.

DESCRIPTION: OUTLINE & MOUNTING, WATER-COOLED V20

PART NUMBER	SEE TABLE	DWG/FILE NUMBER	300-18564-03
SHEET	1 OF 1	DR: pdmndb	DRAWN BY: K. JOHNSON DATE 12-Apr-01
UNITS:	INCHES	CATEGORY:	1 DATE 3/2/2006
SIZE:	B	FINISH CLASS:	A DATE 3.2.06

SYNRAD
SYNRAD INC.
4600 Campus Place
Mukitoo, WA 98275
Phone: (425)349-3500
Fax: (425)349-3667